

Warwickspace Kitchen First Floor

4.9 x 6.7 (16 x 22 ft) excluding the kitchen area

This room can seat 24 people cafe style around square tables or 30 without.

This is a cafe type space with a kitchen to one side. Large windows on the south side making it very light and airy and there are chairs and folding tables available for use. It is mainly used for meetings, dance, music practice, performance rehearsals etc. Craft and cookery sessions are popular uses. There is a lift to the first floor.

There are normally around 8-10 square tables and 16 chairs in this room. If you have specific requirements please let us know when booking this room.

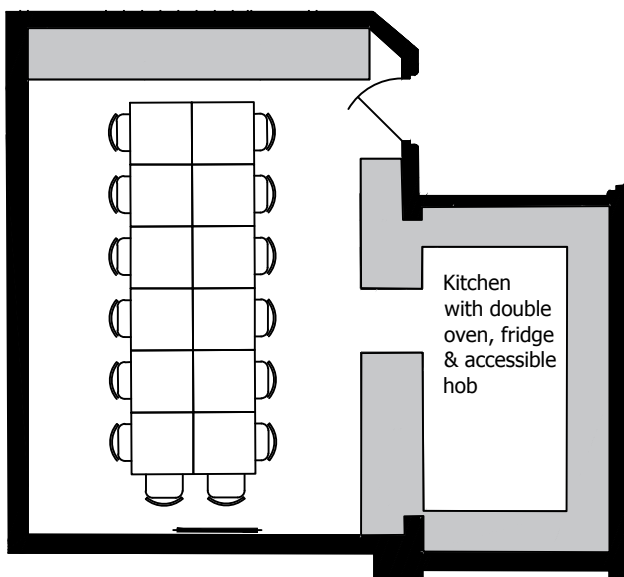

Meeting style 14 people

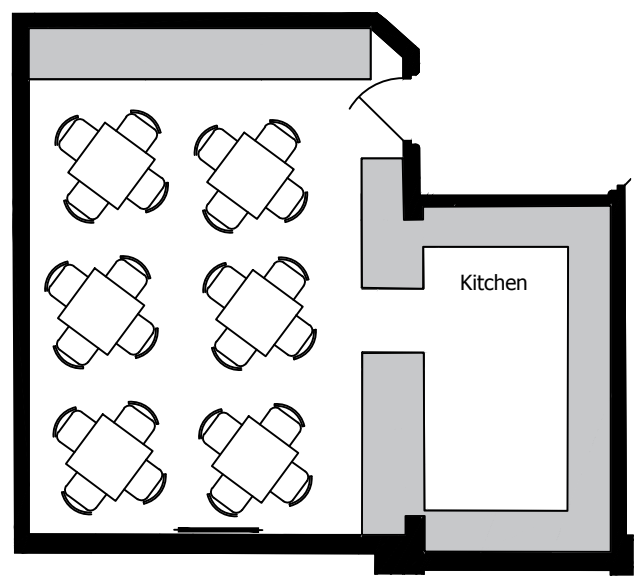

Cafe style 24 people

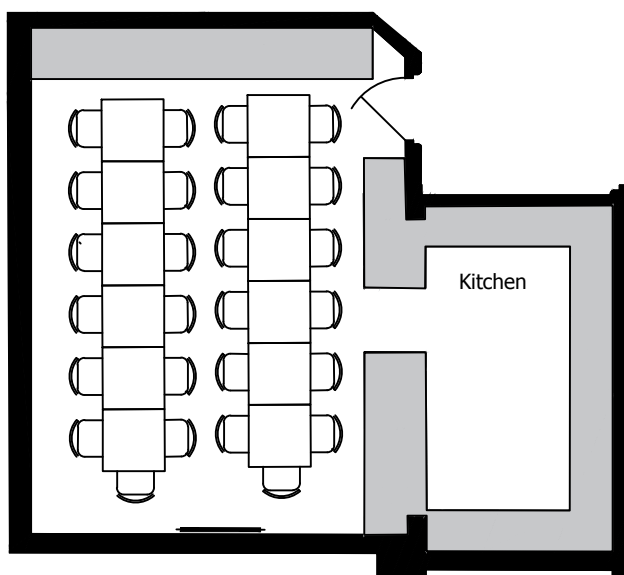

Banquet style: 26 people

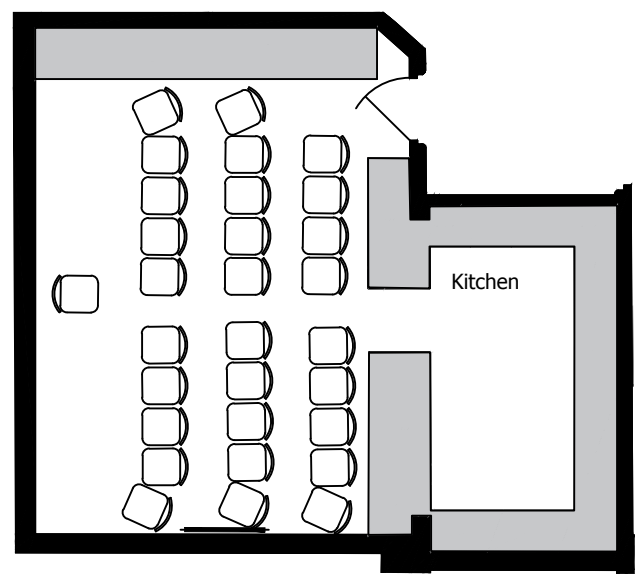

Theatre style: 30 people