

# Warwickspace Hall Ground Floor

8.7 x 14m (28 x 45 ft) These dimensions exclude the stage

Our Hall can accommodate up to 180 people.

This is a large naturally lit space with white brick walls, a set of ballet mirrors and a wooden block floor. Access is from the entrance lobby where a tea station provides a place to make drinks. A kitchen is available to hire separately, on the first floor.

The stage is currently used to store tables and chairs and is not generally available for use. The room will accommodate 100 people auditorium style and up to 180 standing.

There are normally 10 rectangular tables and at least 70 chairs available in this room. If you have specific requirements please let us know when booking the room.

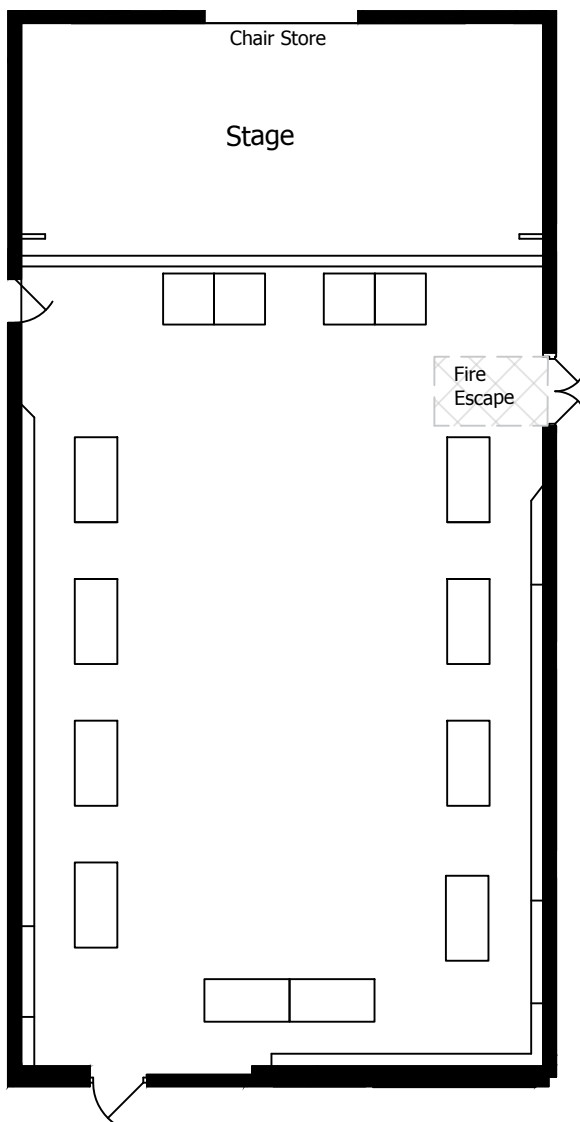

Craft Fair/ Exhibition: 12 tables

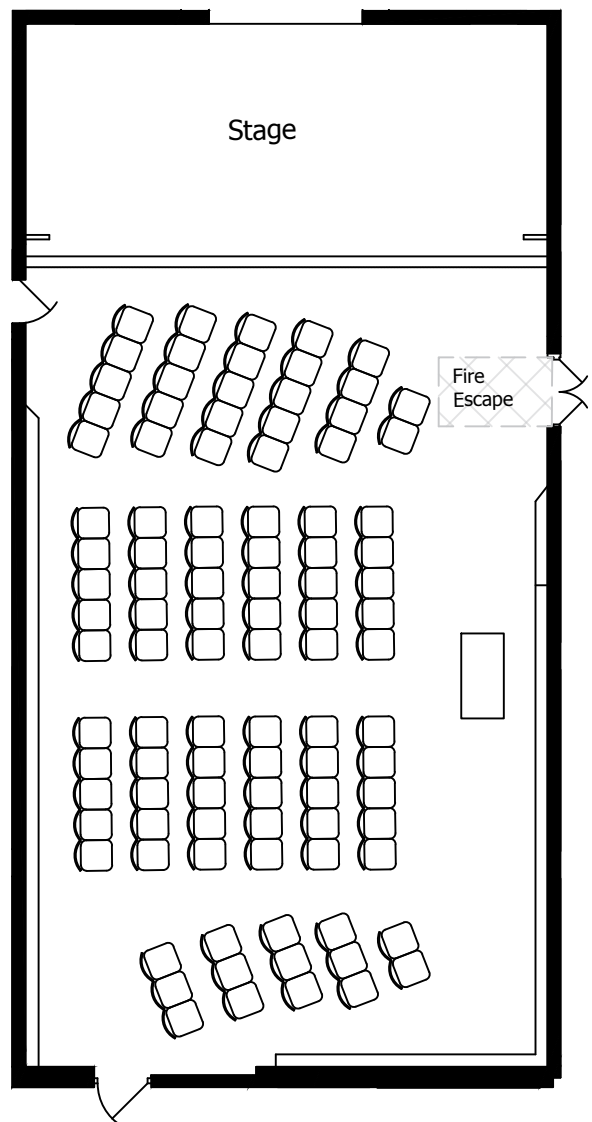

Auditorium Style: 100 people seated

# Warwickspace Hall Ground Floor

8.7 x 14m (28 x 45 ft) These dimensions exclude the stage

Our Hall can accommodate up to 180 people.

This is a large naturally lit space with white brick walls, a set of ballet mirrors and a wooden block floor. Access is from the entrance lobby where a tea station provides a place to make drinks. A kitchen is available to hire separately, on the first floor.

The stage is currently used to store tables and chairs and is not generally available for use. The room will accommodate 100 people auditorium style and up to 180 standing.

There are normally 10 rectangular tables and at least 70 chairs available in this room. If you have specific requirements please let us know when booking the room.

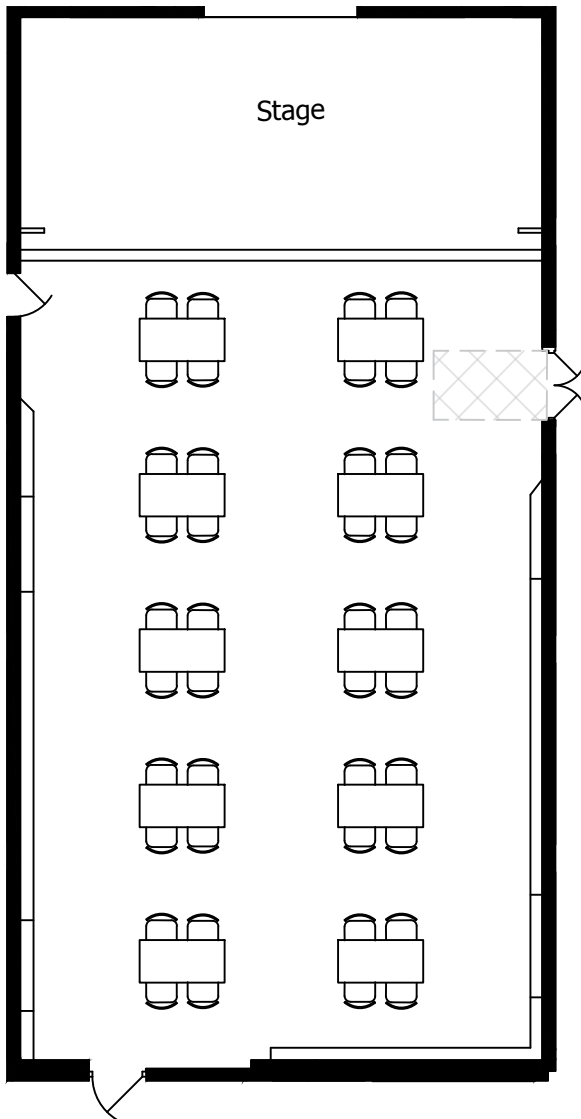

Banquet style: 40+ people seated

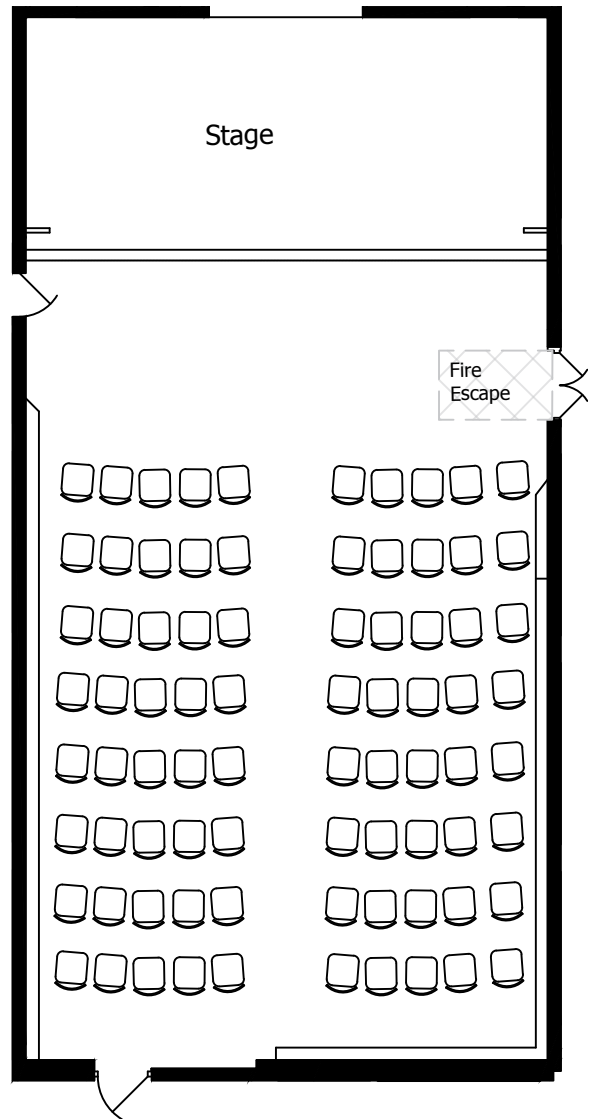

Large Meeting: 80 people seated